



LIFTING CLAMP PLATE HORIZONTAL

**WORKING LOAD LIMIT (WLL)
800 - 16000 kgs.**

- The PDB Horizontal Plate clamps are suitable for lifting and transport of steel plates.
- Construction and profiled bar in horizontal position.
- Manufactured from high quality carbon steel.
- Avoid snatch re shock load the screw jaw of the body can be changed, also have a safety button.



Model :PDB

NB : The top angle between the chain / rope legs must not exceed 45 degree from vertical.



EUROPE MODEL

Suitable for lifting and horizontal transfer of steel plates structures.



SOLID BODY

Made of High - quality Low - carbon alloy steel with a safety button.

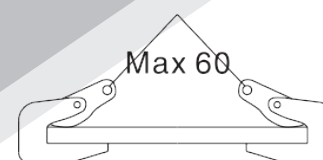
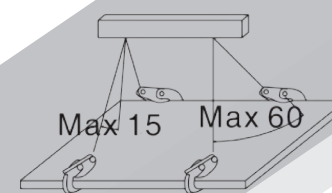
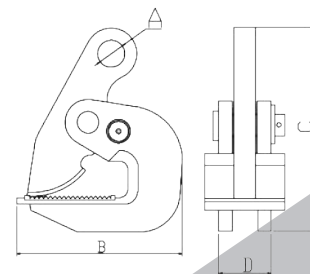

| model | Jaw Opening [mm] | Load Capacity [kg/par] | A (mm) | B (mm) | C (mm) | D (mm) | Weight (kg) |
|---------|------------------|------------------------|--------|--------|--------|--------|-------------|
| PDB 0.8 | 0-25 | 800 | 22 | 125 | 165 | 40 | 2.5 |
| PDB 1 | 0-30 | 1000 | 25 | 148 | 205 | 40 | 3.5 |
| PDB 1.6 | 0-30 | 1600 | 30 | 148 | 205 | 45 | 4 |
| PDB 2 | 0-40 | 2000 | 30 | 172 | 245 | 47 | 5 |
| PDB 3.2 | 0-45 | 3200 | 30 | 180 | 245 | 50 | 6 |
| PDB 4 | 0-50 | 4000 | 30 | 170 | 260 | 52 | 6.5 |
| PDB 5 | 0-55 | 5000 | 30 | 180 | 260 | 56 | 7.5 |
| PDB 6 | 0-65 | 6000 | 37 | 210 | 308 | 62 | 10.5 |
| PDB6B | 0-130 | 6000 | 37 | 316 | 310 | 62 | 22 |
| PDB 8 | 0-100 | 8000 | 55 | 400 | 400 | 65 | 22 |
| PDB 10 | 0-125 | 10000 | 55 | 500 | 500 | 75 | 33 |
| PDB 16 | 100-180 | 16000 | 60 | 410 | 690 | 90 | 51 |

LIFTING CLAMP PLATE VERTICAL

WORKING LOAD LIMIT (WLL) 800 - 30000 kgs.

- Standard design clamp for vertical lifting of steel plates and steel structures.
- The spring - loaded tightening lock mechanism assures a positive initial clamping force.
- Clamps are equipped with a safety mechanism, ensuring the clamp does not slip when lifting force is applied and when load is being lowered.
- High - frequency quenching of die - forged special alloy steels gives greater durability to the cam.



Model :CDH

NB : The plate surface of the material must a hardness level below HRC30 / Brinell 300



JAPAN MODEL

Suitable for lifting and vertical transfer of steel plates structures.



SOLID BODY

Made of High - quality Low - carbon alloy steel with a safety puller.

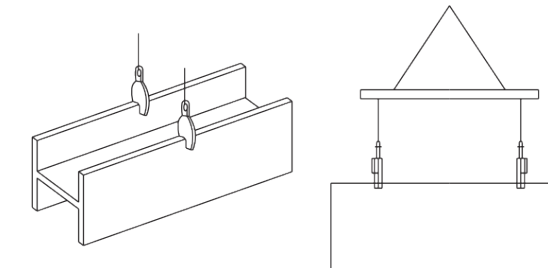

RACHET STRAP

| Model | WLL(tonnes) | Jaw Opening(mm) | Weight(kg) |
|-----------|-------------|-----------------|------------|
| CDH-B 0.8 | 0.8 | 0-16 | 2.8 |
| CDH-B 1 | 1 | 0-22 | 3.6 |
| CDH-B 2 | 2 | 0-30 | 5.5 |
| CDH-B 3.2 | 3.2 | 0-40 | 10 |
| CDH-B 5 | 5 | 0-50 | 17 |
| CDH-B 8 | 8 | 0-60 | 26 |
| CDH-B 10 | 10 | 0-80 | 32 |
| CDH-B 12 | 12 | 25-90 | 48 |
| CDH-B 16 | 16 | 60-125 | 80 |
| CDH-B 30 | 30 | 80-220 | 125 |





PLUS HORIZONTAL LIFTING CLAMP

- This LC clamp is used for horizontal lifting and transfer of steel. Working fields plates and is particularly suited to this application due to the special thing round plate and buffer cams which facilitate easy insertion and removal under the plate being lifted. It can also be used hanging vertically under a spreader.
- These clamps are light in weight relative to their lifting capacity.
- Please note that the WLL of these clamps is given based on apai.
 - 1.At building construction field
 - 2.At shipbuilding field for surface hardness esupto37RC(345HB) .
 - 3.Metal production workshop
 - 4.At subway construction(civil engineering construction) sites



Model :LC

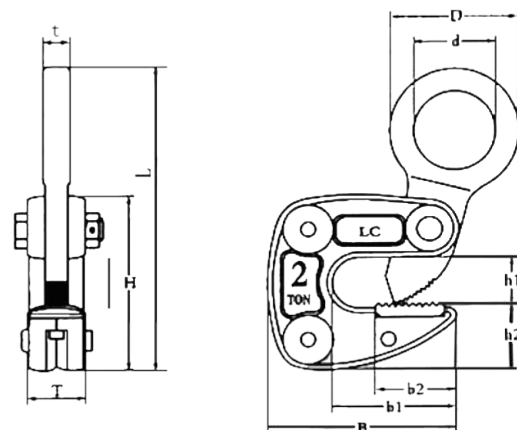

- Safety technical features
 1. Embossed branding, Plcode for good trace ability and quality guarantee.
 2. All forged parts with stock availability at anytime
 3. High strength and durability with MBL of 500% of capacity, or better.

Jaw and floor Material: 35Cr Mu Ti Meets standard BS EN 13155

| Item No. | WLL (t/pair) | Opening (mm) | L | t | T | Dimensions(mm) | | | B | b1 | b2 | D | d | Weight (kg) |
|----------|-----------------|-----------------|-----|----|----|----------------|----|----|-----|----|----|----|----|----------------|
| | | | | | | H | h1 | h2 | | | | | | |
| LC1 | 1 | 1~13 | 166 | 12 | 32 | 100 | 22 | 36 | 102 | 64 | 42 | 70 | 46 | 2.1 |
| LC2 | 2 | 3~22 | 235 | 16 | 40 | 132 | 33 | 46 | 130 | 84 | 56 | 92 | 56 | 4.7 |
| LC3 | 3 | 12~35 | 276 | 18 | 44 | 178 | 40 | 66 | 172 | 92 | 70 | 82 | 42 | 8.4 |

PLATE LIFTING CLAMP

Technical Specialities

- The universal vertical CD clamp is designed to ensure that the load can be lifted and turned(180°) .Whilst at the same time ensuring that the load is positively retained.
- These clamps have a wide range of uses and are particularly suited for the lifting and turning of steel plates, ship sections and the extraction of pile sheets.

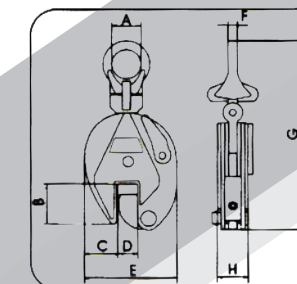

Model :CD



- The clamp is fitted with a safety latch which ensures the proper use by means of a double locking device, both in open as well as closed position.
- This also guarantees a pre-load on the material being lifted.

| Model | WLL (tonnes) | Jaw Opeing (mm) | Weight (kg) |
|----------|-----------------|--------------------|----------------|
| CD0.8 | 0.8 | 0-15 | 2 |
| CD1 | 1.0 | 0-15 | 4 |
| CD1(B) | 1.0 | 0-20 | 5 |
| CD1.6 | 1.6 | 0-20 | 7 |
| CD2 | 2.0 | 0-25 | 8 |
| CD3.2 | 3.2 | 0-25 | 15 |
| CD3.2(B) | 3.2 | 0-30 | 15 |
| CD5 | 5.0 | 0-30 | 21 |
| CD5(B) | 5.0 | 0-50 | 23 |
| CD8 | 8.0 | 0-45 | 37 |
| CD12 | 12.0 | 0-70 | 50 |
| CD16 | 16.0 | 60-100 | 65 |
| CD30 | 30.0 | 60-220 | 120 |